



OWNER'S MANUAL

Assembly & Operational Instructions



INDIA'S NO 1 BRAND

STREET BIKE

SERIES

HARLEY QUINN BIKE

IS15644:2006



CM/L6700079217

www.bis.gov.in

* Also Comply with International Safety Standard

ISO8124, En71, ASTM F963, ST, GCC, AS/NZS 8124, CCPSA, 55474

ABOUT "LEOTOON" PRODUCT

Thank you for purchasing leotoon Ride-ons. We have devoted ourselves to create comfortable and safe electronic toys, thus offering a colorful childhood for your children.



It is very important to read these instructions carefully before usage. This instruction Book not only specifies assembly process but also proper application method. It also helps to avoid injury or damage to the product in case of incorrect operation.



This product can be operated in Battery Operated mode with Forward, Reverse, Left, Right, and equipped with functions like headlight, built-in music playing.

If you are missing a part, please call us at +91 9176-796-955 or write to director@parultoy.com rather than return this product to the store.

Wipe the surface of the each part with a clean, and cloth to remove any dust or oils.

Please identify all parts before assembly and save all packaging material until assembly is complete to ensure that no parts are discarded.

All parts to be assembled by customer only

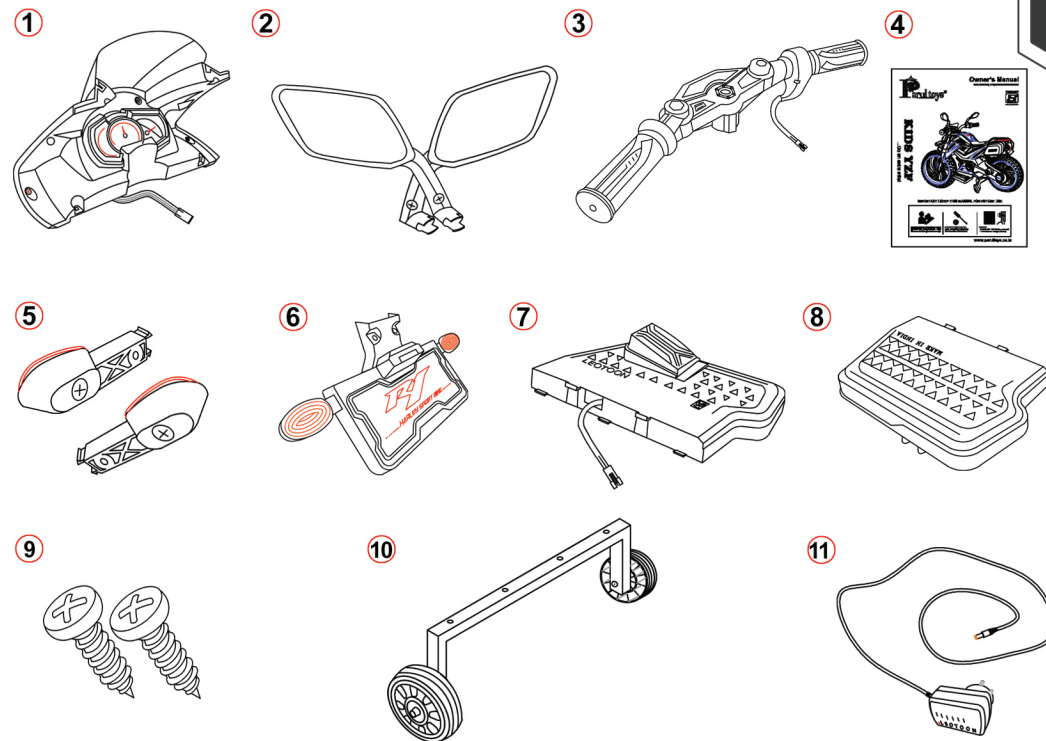

SPECIFICATION

Model Number	LFB-R1 Mini 2 Wheel
Battery Specification	1B (6V/5AH) VRLA Battery
Motor Specification	1M (380) 6V/16000 RPM
Accelerator	Hand Accelerator
Age	3Y+
Package Dimensions	L81 * W32 * H47 (Cm)
Product Dimensions	L90 * W45 * H60 (Cm)
Gross Weight	8.980 Kg
Net Weight	7.720 Kg
Input Power Supply	AC 220~240V; 50Hz
Output Power Supply	DC 12V/1000mA
Charging Time	8~12 Hours
Running Time	2~3 Hours
Rechargeable Life	About 300 Times

LFB-R1 Harley Quinn Parts List Details

1	Bike Doom	7	Right Foot Brake	13	
2	Rear Vire Mirror	8	Left Foot Padel	14	
3	Bike Handle	9	Head Screws	15	
4	Owner's Manual	10	Support Wheel	16	
5	Side Indicator-4U	11	6V Charger	17	
6	Number Plate	12		18	

LEOTOON R1 HARLEY QUIENN BIKE DIY ASSEMBLY VIEWS

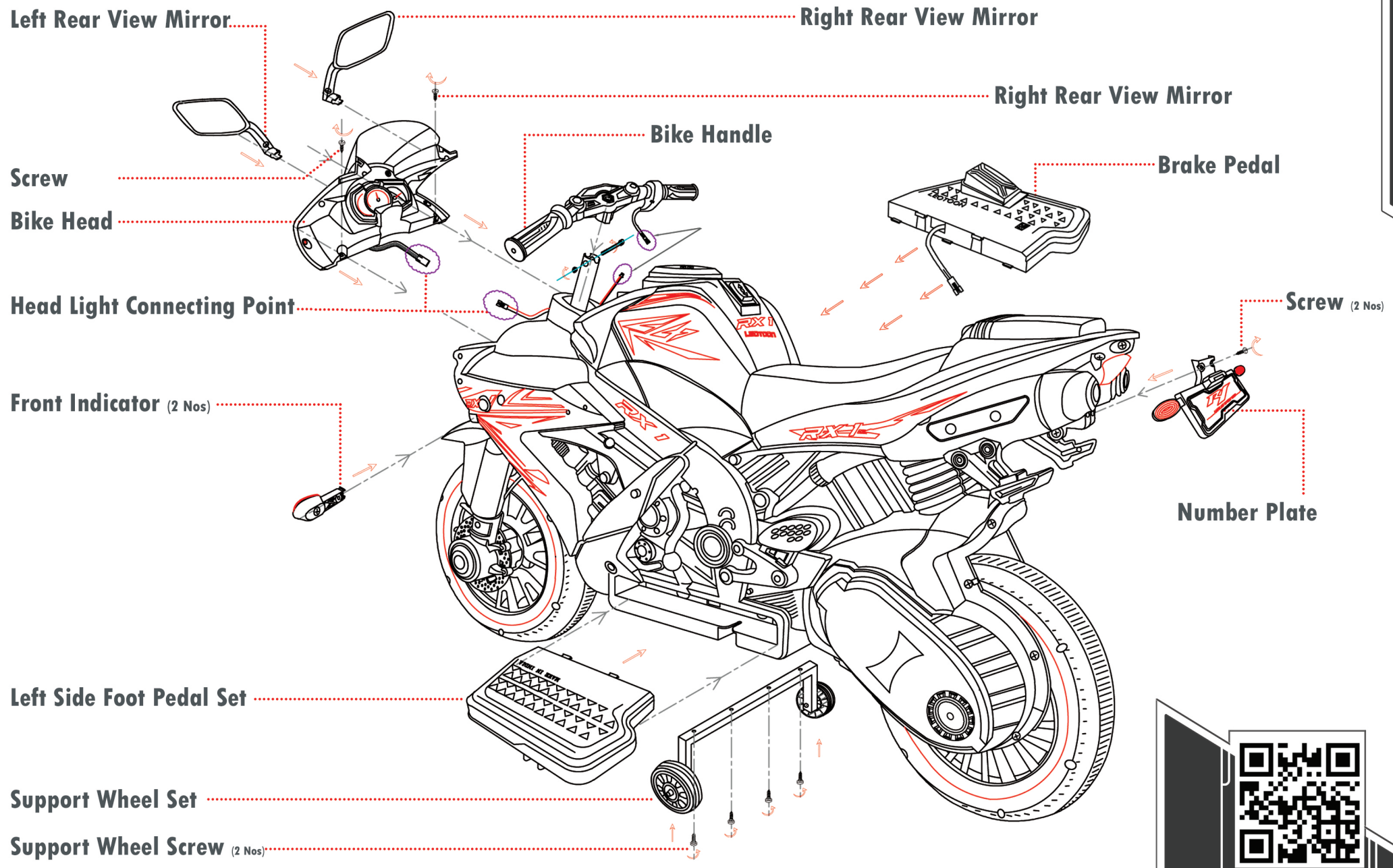

SCAN FOR MORE DETAILS
www.parultoy.com

BATTERY AND FUSE CONNECTION VIEW

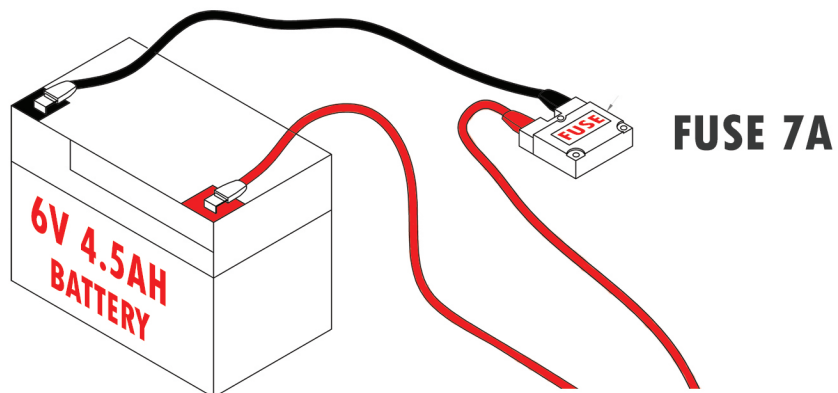

Possible Cause : Thermal fuse has tripped.

The car is equipped with a self-resetting fuse. When the car is overloaded or operated incorrectly; the self-resetting fuse will be cut off for 60 seconds before becoming operational again. The Self-resetting fuse is under the seat (Refer to the picture).

To Avoid the fuse cut off the power, follow these guidelines:

DO NOT overload the car, Maximum weight allowed: 30kg
 DO NOT tow anything behind the car.
 DO NOT drive up steep slopes.
 DO NOT drive into fixed objects, which may cause the wheels to spin, causing the motor to overheat.
 DO NOT drive in very hot weather, components may overheat.
 DO NOT tamper with the electric system, doing so may create a short circuit, Causing the fuse to trip.

Possible Cause : Battery Connector or wires are loose.

Make sure the battery connectors are firmly plugged into each other.

Possible Cause : Battery is dead.

Have you properly maintained the battery according to the directions ? Is the battery Old ? Your battery may need to be replaced.

Possible Cause : Electric System is Damaged & Motor is damaged.

Water may have corroded the system, or loose dirt, gravel or sand might have jammed the switch. The motor needs professional repair.

Problem : The Battery Will Not Recharge.

Battery connector or adapter connector is loose. Make sure the battery connector and adapter connector are firmly plugged together.

Charger is not plugged in. Make sure the charger is plugged into the wall outlet and the power flow to the outlet is on.

Charger is not working. Is the charger working while charging ? If not, charger may not work properly and may need to be replaced.

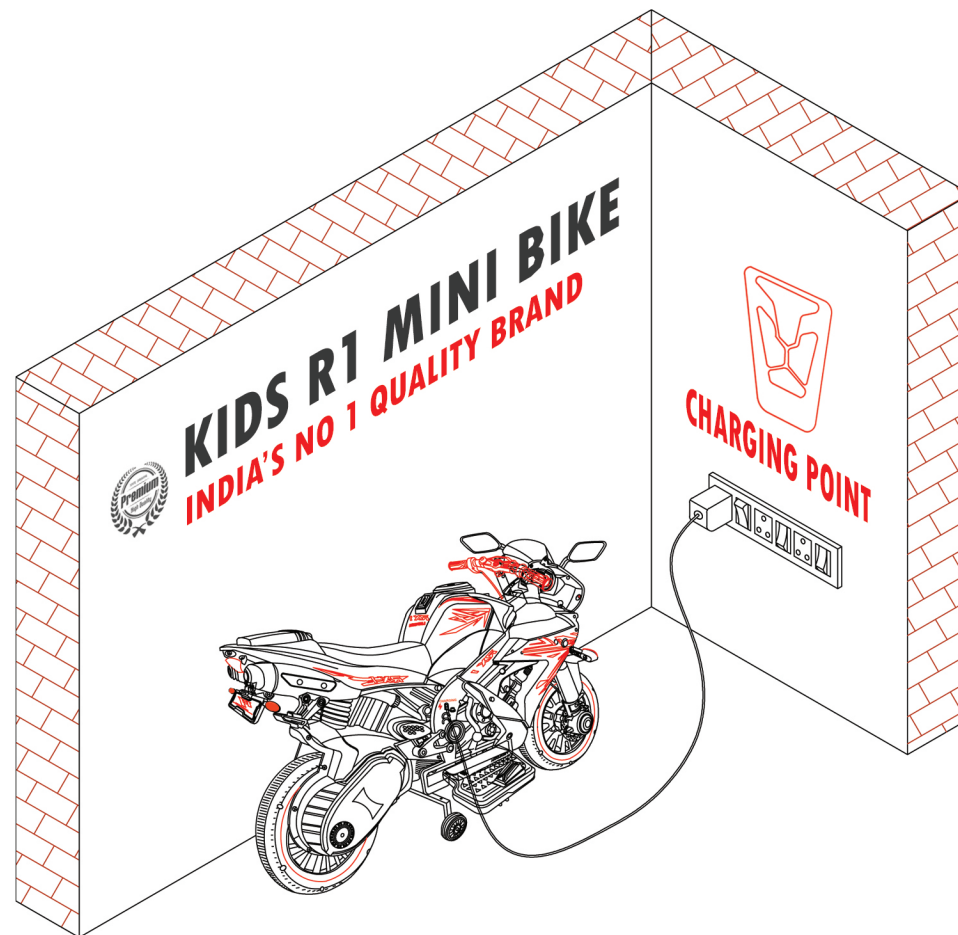

BATTERY CHARGING

First plug the charger connector into the battery socket. Then plug the charger into a standard wall outlet. Use the charger only in a wall outlet. Do not plug the charger into a ceiling outlet.

If power flow to the wall outlet is controlled by a switch, make sure the switch is "ON"

Once the battery is charged, remove the charger connector from the battery and then unplug the charger from the wall outlet. Refer to the battery installation section for instructions to install your battery. If your battery is already installed in your vehicle, simply reconnect the motor harness connector to the battery.

Adults Note: Periodically examine this battery charger for damage to the cord, housing or other parts that may result in the risk of fire, electric shock or injury. If the battery charger is damaged, do not use it.

Make sure you charge the battery for at least 18 hours using the enclosed 12 volt charger before operating your vehicle for the first time.

Charge the battery for at least 12 hours after each use of the vehicle.

Do not remove the battery from your vehicle to recharge it. Never charge the battery longer than 24 hours. Failure to follow these instructions may damage your battery and will void your warranty.

Before charging the battery, examine the battery case for cracks and other damage which may cause electrolyte to leak during the charging process. Battery acid is very corrosive and can cause severe damage to surface it contacts with.

Charge the battery in a well ventilated area.

PARTS AND ACCESSORIES ASSEMBLY STEPS

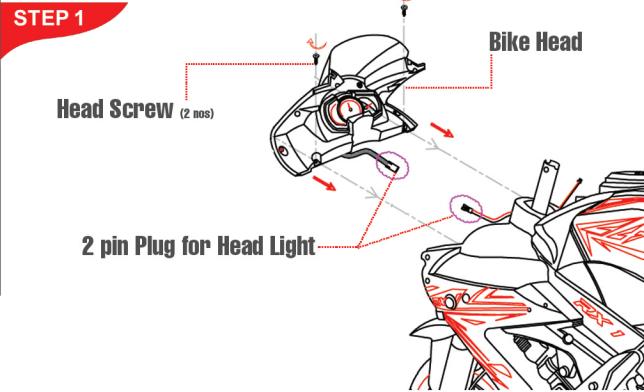

Head Assembly

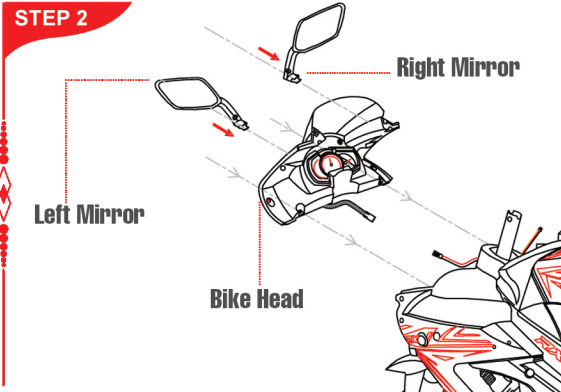

Mirror Assembly

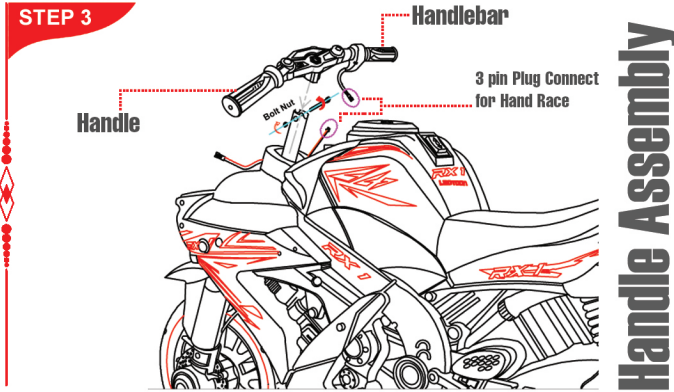

Handle Assembly

Step 1A : Please Connect the 2 Pin Plug For HeadLight
Step 1B : Screw Fit the Head to Bike

Step 2A : Snap Fit the Rear View Mirror to Bike

Step 3A : Please Connect the 3 pin Plug to Bike
Step 3B : Fix the Handle to Bike

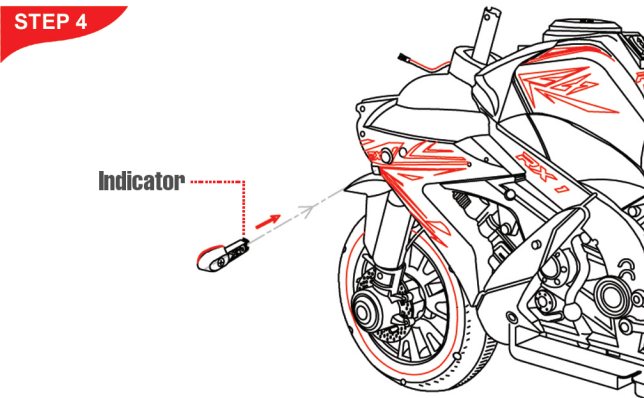

Indicator Assembly

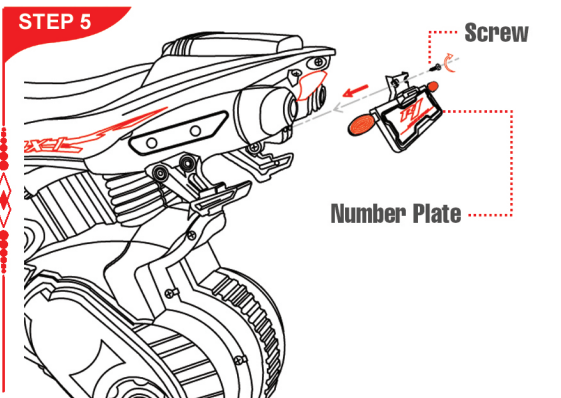

Front Wheel Assembly

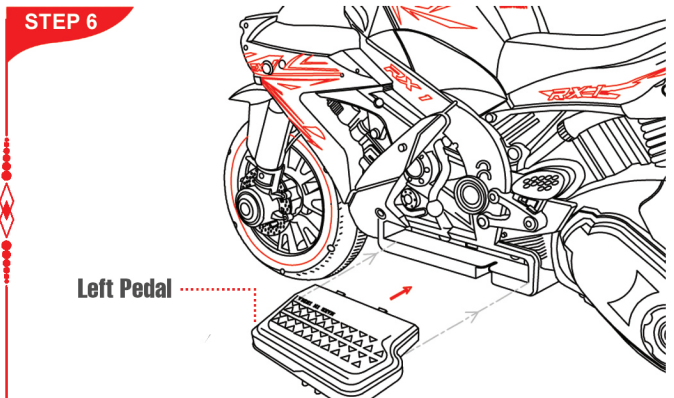

Left Pedal Assembly

Step 4A : Snap Fit the Indicator to Bike (Right and Left Side)

Step 5A : Fix the Front Wheel

Step 6A : Please fix the Left Pedal Press to Bike bottom Inside

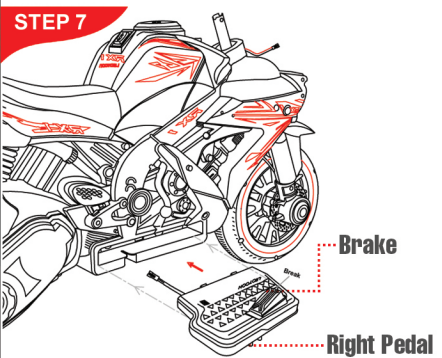

Right Pedal Assembly

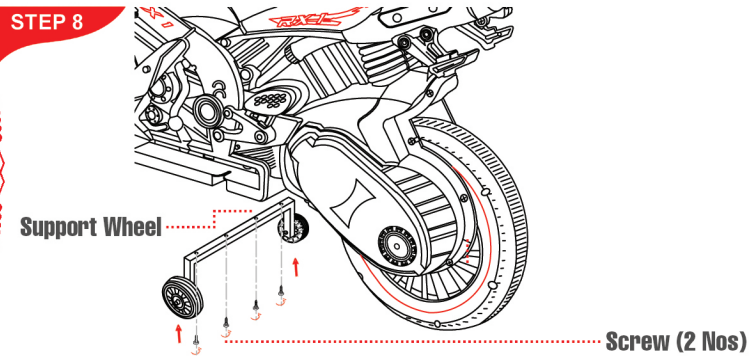

Back Wheel Assembly

Step 7A : Connect the 2 Pin Plug for Brake
Step 7B : Please fix the Brake Pedal to Bike

Step 8A : Screw fix the Support Wheel Rod to Bike

Assembly Steps

- * This product requires adult assembly. Please set aside at least 40 minutes for assembly.
- * Children can be harmed by small parts, sharp edges and sharp points in the vehicle's unassembled state. Care should be taken in unpacking and assembly of the vehicle. Children should not handle parts, or help in assembly of the vehicle.
- * Please identify all parts before assembly and save all packaging material until assembly is complete to ensure that no parts are discarded.
- * Assembly tools needed: **Screwdriver (Not included), Pliers (Not included), Spanner (Not Included)**





LEOTOON

LEOTOON INDIA PRIVATE LIMITED

Plot 23-24, Sumangali Nagar, Vadapeumbakkam, Chennai 600060.

Contact : +91 917 679 6955



Follow us : /leotoonindia